

B

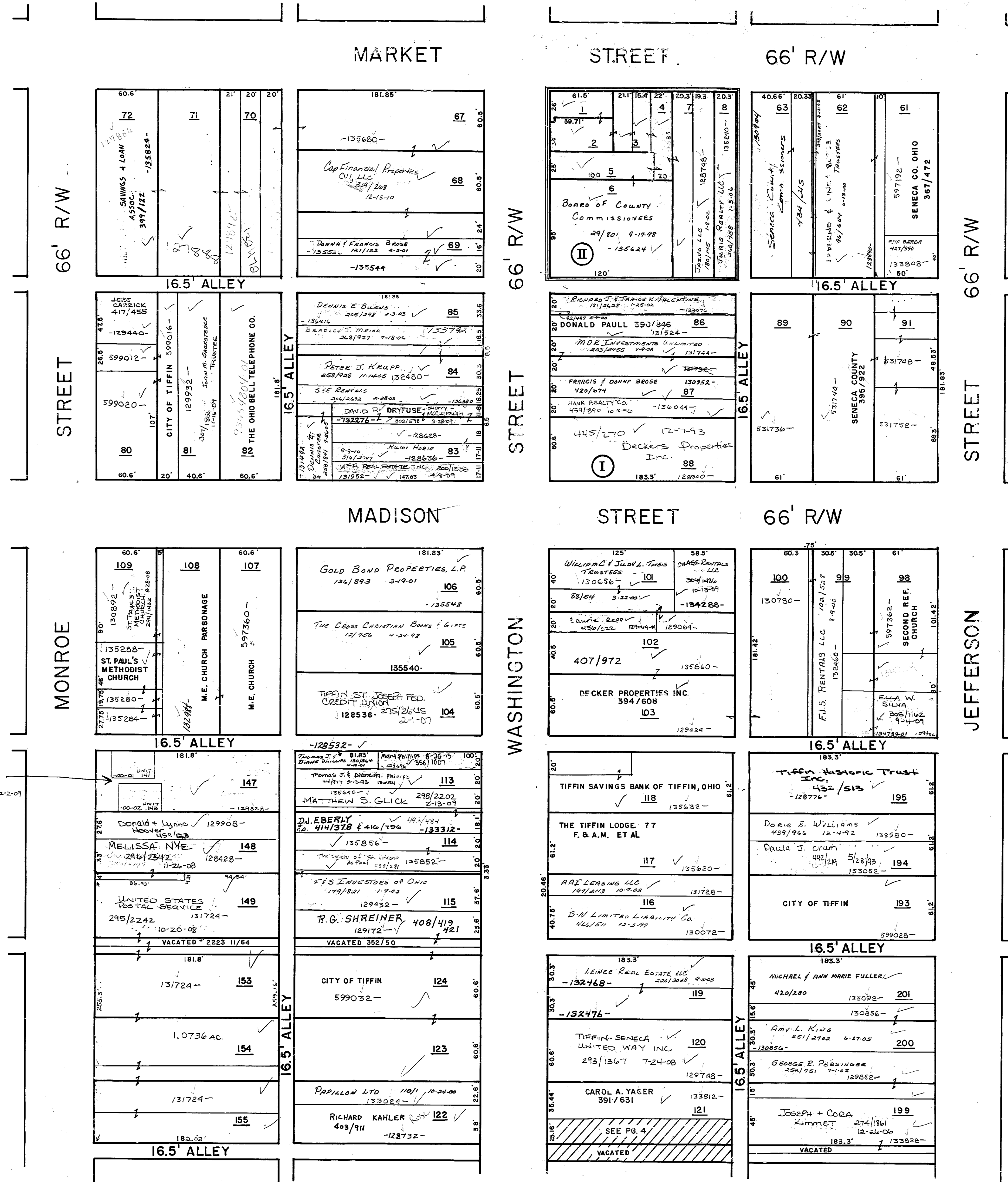

HEMING'S RESURVEY
JOHN LOOMIS ET AL by appr. 1890

I V.3, P. 39
II 3, 18

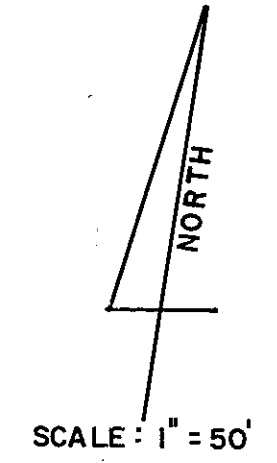

— LOT BOUNDARY LINE
— LOT DIVISION LINE
— SEPARATES SUB-DIVISIONS

CAB. 3 SLOTS 90A+B and 91A
308/237 MONROE ST. CONDOMINIUM
12-2-09
UNIT 141 (00-01) THE OLD FORT BANK 308/272 12-2-09
VANESSA + ARNER
UNIT 143 (00-02) CORDERO MD 308/275 12-2-09

STREET 66' R/W

WASHINGTON STREET

STREET 66' R/W

MONROE STREET

STREET 66' R/W

JEFFERSON STREET